



SMART LOCK
6016

The future hotel's best choice

The future hotel's best choose

We have more than 20000 users worldwide, more than 3000000 hotel rooms are using our hotel intelligent lock. Network covering more than 30 countries.

We constantly improve products and services, give the customers home feeling .

Our intelligent locks for 6016 model, use the advanced material, perfect craft.It's very suitable for the seaside tourism city's hotel. This lock has alarm function to prevent the malicious user the clink.

We open lock using non-contact way, greatly reducing the card to the hotel owner cost overhead .

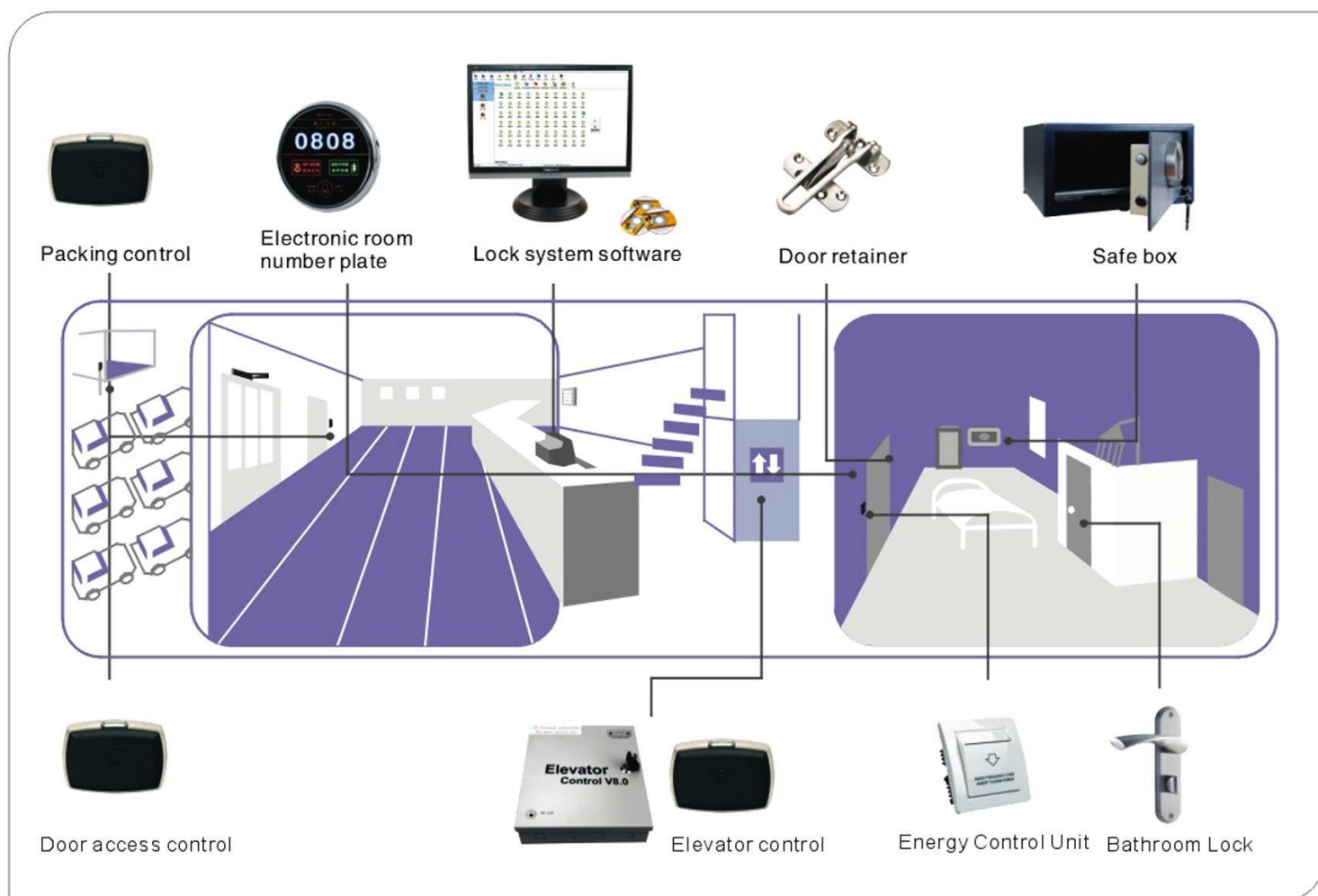



The 6016 RFID hotel lock is thus equipped with a built-in alarm, which is activated when the door is not properly closed.

And this smart door lock system has open the door, get power, parking, access control, lift controller, consumption, such as IC card function, for the customer and hotel management to bring real, great convenience .

The 6016 RFID hotel lock is beneficial in its acquisition when compared to many other locks, while it is a high quality. From materials ,chips, Surface process, etc.

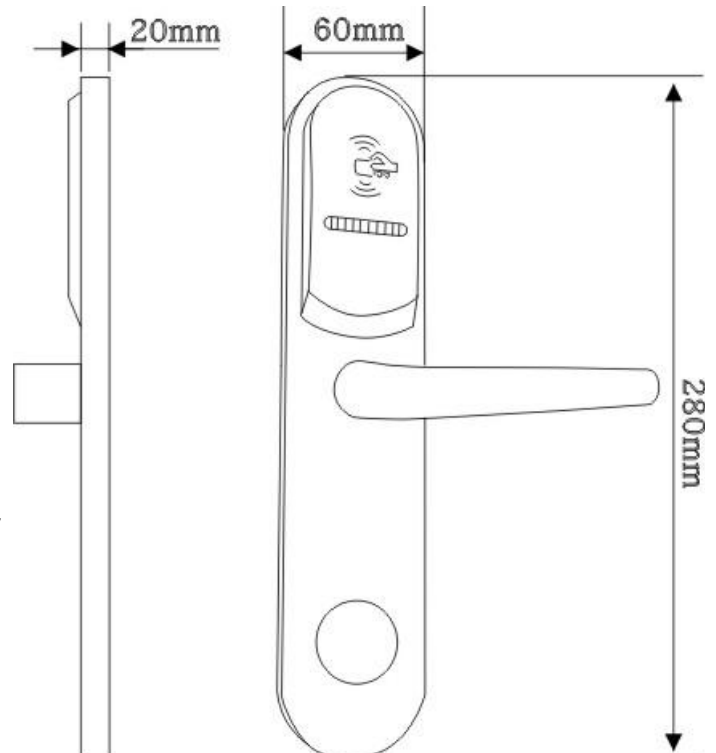

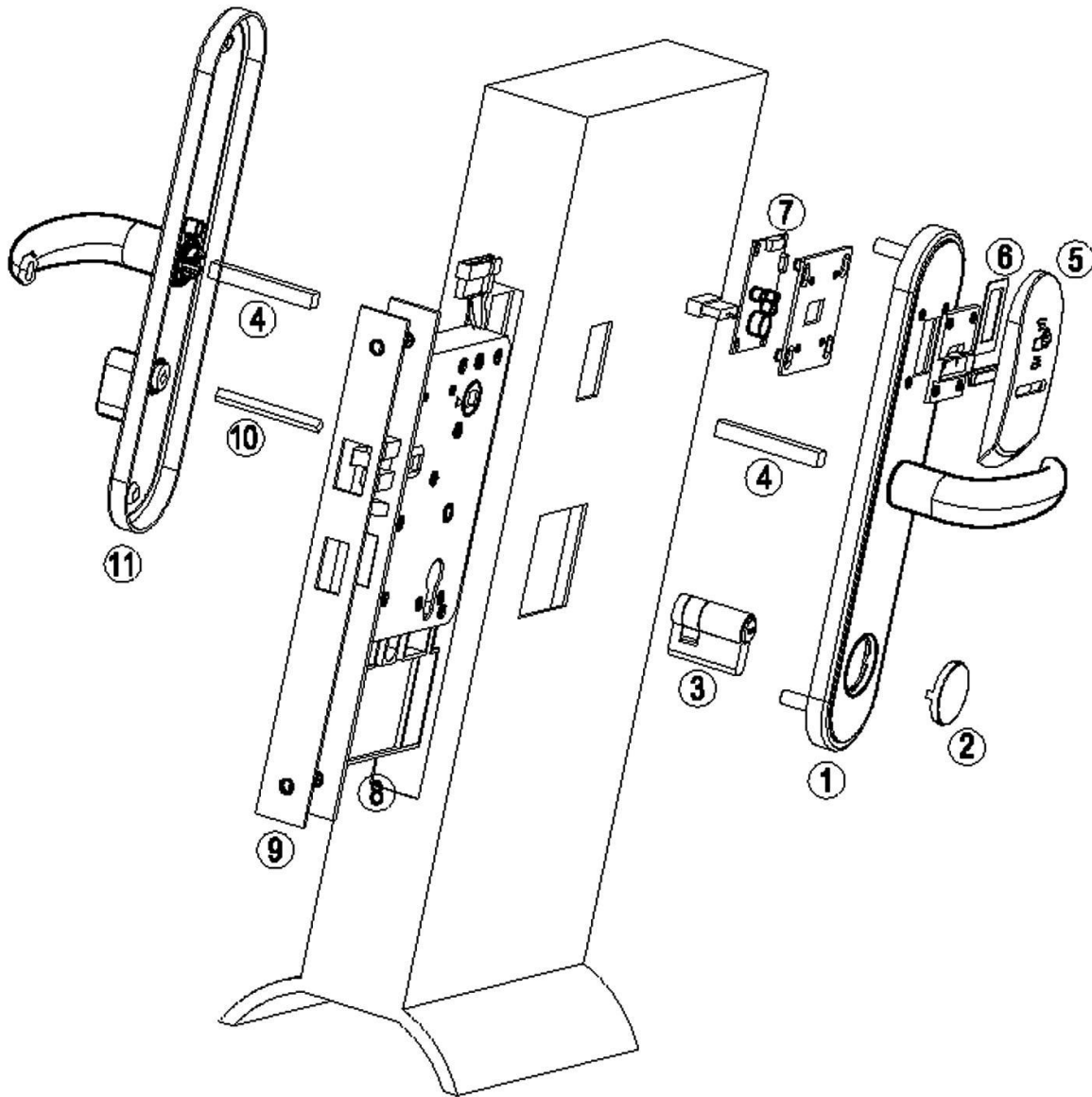

MF Electronic Lock Technical Parameters

Opening Time: Press down the handle for once, the lock auto-locks when door is not opened;

Clutch: Imported micro-motro;

Card type: Mifare sensor card(expanded one-card-pass function);

Theoretical quiescent dissipation: 8~15 microamp;

Installation space: door thickness 38~60mm(lengthened parts should be needed if the door is

overthick). If there is decorative border on the door, then decorative border should have a at least 115mm distance to the edge;

Record storage: can store almost 2000 records, including unlocking records of mechanical key.

Low voltage warning: when the voltage is below 4.7v, the lock will warn by light and voice, and it can still unlock the door 500 times by this time.

Mechanical key: Mechanical key which is prying resistant is equipped to ensure the door can be open in the emergency. It can be made to single opening (one-for-one) or one key can open all the lock(master key).

Lock Material: use stainless steel, very durable;

Surface Treatment: Nanotechnology is used to treat the surface of lock so that the lock is anticorrosion and wear prevention;

Lock handle: idling design, free handle to effectively prevent any damage to the inside structure from external force;

Unlocking ways: RF card electronic key(essential), mechanical key (essential), 5 seconds emergent opening time;

Lock tongue: use international standard five bolts; the prevent breaking bolt can efficiently prevent breaking and theft;

Surface of mortise: use international standard treatment technology, prevent corrosion and moisture;

Double lock function: 4 bolts locked outside the door, 5 bolts locked inside the door;

Mortise: ANSI mortise, solid and durable.

Electronic Circuit

Computer board,control board: totally computer test, anti-jamming design, anticorrosion and antimoisture processing is operated to ensure the circuit run stably.

Motor and clutch: gear with steel type, avoid the normally open or close state caused by motor stuck resulting from wear and tear and the shake from closing the door. Meanwhile ensure it run freely for at least 500,000 times.

Winding displacement of motor: use flame retardant material, and additional drivepipe is used to strengthen the protection.

Intelligent Function

Confidentiality:Information written is encrypted, and only our system can read the information, other system cannot read out the data.

Auto alarm function: When the door is not closed right or in the false close state(some of the bolts don't pop out), the lock will gives a warning signal 5 sec after the door closed; when the voltage is below 4.7v, the lock will warn by light and voice when using RF card to open the door, and it can still unlock the door 500 times by this time.

Memory function: The computer chip of the storage inside the lock can store 2000 records, including unlocking records of RF card and mechanical key and other unlocking ways. The data will not lose even the power is off, and the unlocking records can be read out at any time.

PDA hand held function: the specialized PDA can fulfill fault diagnosis,clock setting, lock maintaining, unlocking records reading function to the lock.

Power saving funcion: the micro computer board come to sleep mode when it is not running.

Card set and loss reporting function: we can set the card function and report the loss of the



card through lock management system.

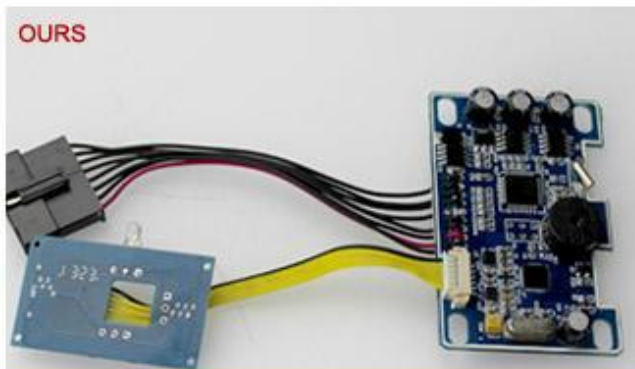

Pcb board:Independent clock chip
MF chip never loss information

VS
1



Pcb board:no Independent clock chip
MF chip often loss information

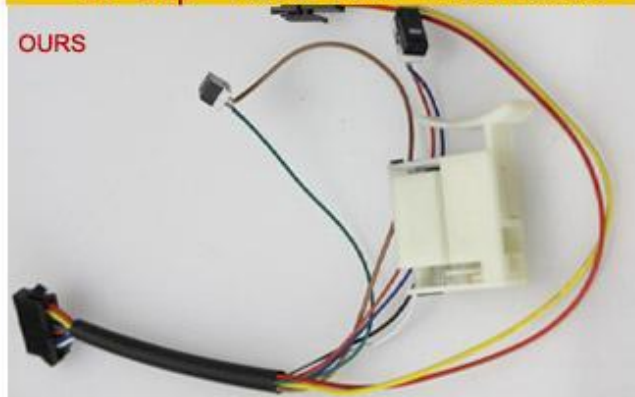

Motor:Imported from Japan Mabuchi
Stable performance, reliable

VS
2

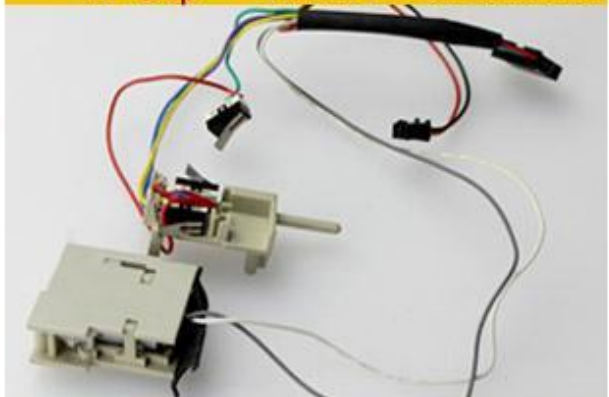

Motor was made in China
It has poor road-holding in wet conditions



Europe Machine key:install very easy
Improve work efficiency

VS
3



ANSI Machine key:need screws fixed
behind the mortise,very difficult

Anti-jamming function: prevent the disturbance from outside magnetic field,etc;

Expanded one-card-pass function: RF card has its compatibility to other type of card and device, it can fulfill the one-card-pass function, like parking lot, elevator controller, inductive electronic swith, etc.

The 6016 RFID hotel lock is equipped with durable contactless card technology, which is insensitive to scratches and magnetic fields. The battery has a high longevity (normal 4pcs AA batteries can use 14 months) and both the locks and cards are low-maintenance. The locks are standard equipped with an emergency cylinder and a special fire prevention card to keep the doors open during an emergency.



Our user group is growing!

We constantly explore the user requirements, providing humanized service, convenient and reliable products .



Karben Tec provides safety- and comfort products for every segment of the hotel industry. However, this does not only pertain to the supplying of products.

Karben Tec has its own Research & Development department where innovative products are developed and produced. Quality and competitive pricing take precedence, while sustainability and care for the environment do not get ignored. Karben Tec is the market leader in the Benelux countries and has a global service network.

We see to the transport, delivery and assembly ourselves. This enables us to offer you the best possible products and service. We have sales channels in a lot of countries around the world and tourism cities. Discover what Karben Tec can do for you business on www.Karben Tec.com

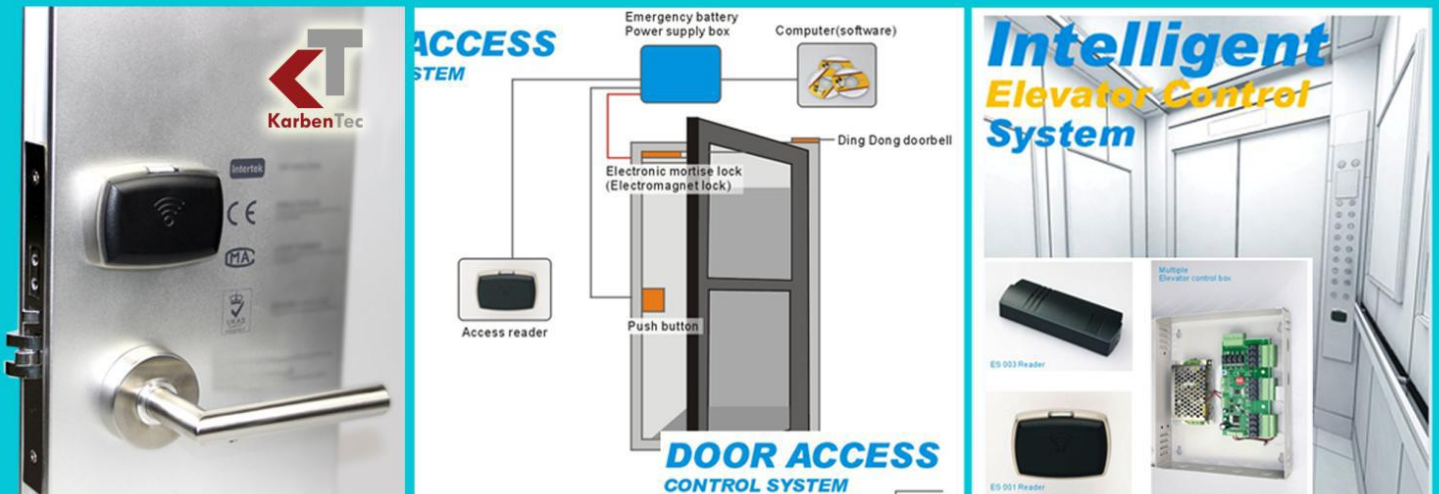

hotel lock

door access

lift controller

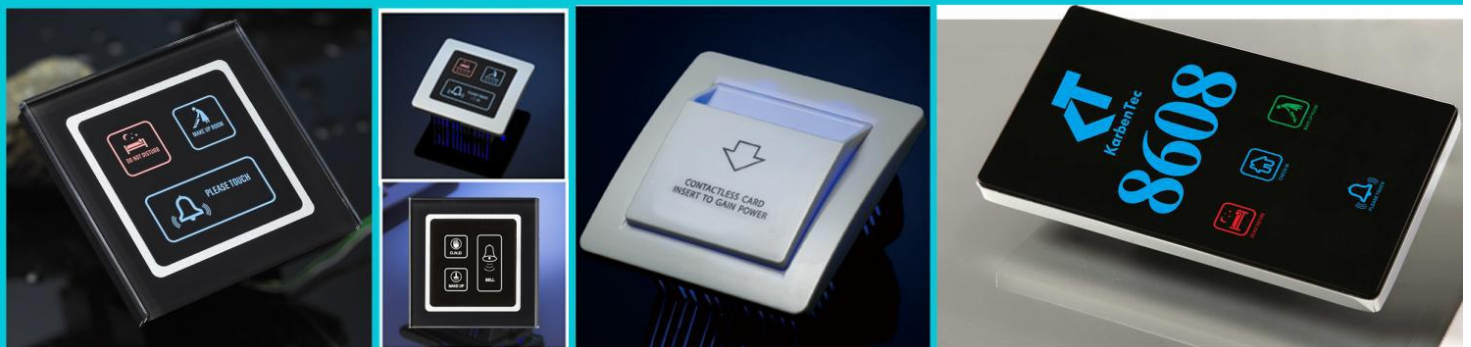

smart DND switches system



The 6016 RFID HOTEL LOCK has got Intertek En14846 certification.



